

# 700T series Slew drives



Bonfiglioli 700T series provide the safest and most effective solution for cranes, excavators and forestry machines. Highly appreciated by all the major manufacturers, the 700T Series have long been established in the cranes, excavators and special equipment industries.



### Torque Range

1000 ... 80000 Nm

### Gear Ratios

3.4 ... 2000

### Key Features

- Flange mounted
- Output shaft: splined or with integral pinion
- Rugged construction
- High torque capacity
- Output shafts supported by heavy duty capacity bearings

### Hydraulic motor options

- Pressure relief valve
- Overcenter valve

### Hydraulic Brake

- Hydraulically released parking brake on request

### Electric Brake

- DC and AC type

| Type  | (Nm)  |
|-------|-------|
| 700 T | 1000  |
|       | 1200  |
| 701 T | 1800  |
|       | 2400  |
| 703 T | 2500  |
|       | 3500  |
| 704 T | 3600  |
|       | 4800  |
| 705 T | 5000  |
|       | 6500  |
| 706 T | 7500  |
|       | 10000 |
| 707 T | 9000  |
|       | 15000 |
| 709 T | 12000 |
|       | 20000 |
| 710 T | 18000 |
|       | 30000 |
| 711 T | 20000 |
|       | 35000 |
| 712 T | 30000 |
|       | 45000 |
| 713 T | 40000 |
|       | 55000 |
| 714 T | 50000 |
|       | 65000 |
| 715 T | 70000 |
|       | 80000 |

■ Excavator Torque  
■ Crane Torque



## Overall dimensions and technical data

| TYPE    | RANGE OF RATIOS | MAX. INPUT SPEED | HYDRAULIC MOTOR DRIVE <sup>(1)</sup> | BRAKING TORQUE | MIN. OPENING PRESSURE | WEIGHT | DESIGN |
|---------|-----------------|------------------|--------------------------------------|----------------|-----------------------|--------|--------|
|         | max/min         | bar              |                                      | Nm             | bar                   | Kg     |        |
| 700 T F | 3.48-7.2        | 500              | LS                                   | 50 - 400       | 10 - 30               | 22     | A      |
| 701 T F | 3.48-7.2        | 500              | LS                                   | 50 - 400       | 10 - 30               | 27     | A      |
| 703 T F | 12-44           | 3000             | HS                                   | 50 - 400       | 10 - 30               | 45     | A      |
| 704 T F | 12-44           | 3000             | HS                                   | 50 - 400       | 10 - 30               | 50     | A      |
| 705 T F | 12-44           | 3000             | HS                                   | 50 - 400       | 10 - 30               | 55     | A      |
| 705 T L | 12-44           | 3000             | HS                                   | 50 - 400       | 10 - 30               | 80     | B      |
| 706 T N | 15-46           | 3000             | HS                                   | 400 - 1000     | 20 - 30               | 95     | B      |
| 707 T N | 17-47           | 3000             | HS                                   | 400 - 1000     | 20 - 30               | 140    | B      |
| 709 T N | 17-47           | 3000             | HS                                   | 400 - 1000     | 20 - 30               | 165    | B      |
| 710 T N | 19-38           | 3000             | HS                                   | 400 - 1000     | 20 - 30               | 250    | B      |
| 711 T C | 14-39           | 3000             | HS                                   | 400 - 1000     | 20 - 30               | 300    | B      |
| 711 T F | 14-39           | 3000             | HS                                   | 400 - 1000     | 20 - 30               | 160    | A      |
| 712 T F | 80-200          | 3000             | HS                                   | 400 - 1000     | 20 - 30               | 450    | A      |
| 712 T N | 80-200          | 3000             | HS                                   | 400 - 1000     | 20 - 30               | 450    | B      |
| 713 T N | 50-300          | 3000             | HS                                   | 400 - 1000     | 20 - 30               | 500    | B      |
| 714 T F | 90-180          | 3000             | HS                                   | 400 - 1000     | 20 - 30               | 160    | A      |
| 715 T N | 57-250          | 3000             | HS                                   | 400 - 1000     | 20 - 30               | 650    | B      |

(1) LS = Low speed motor / HS = High speed motor

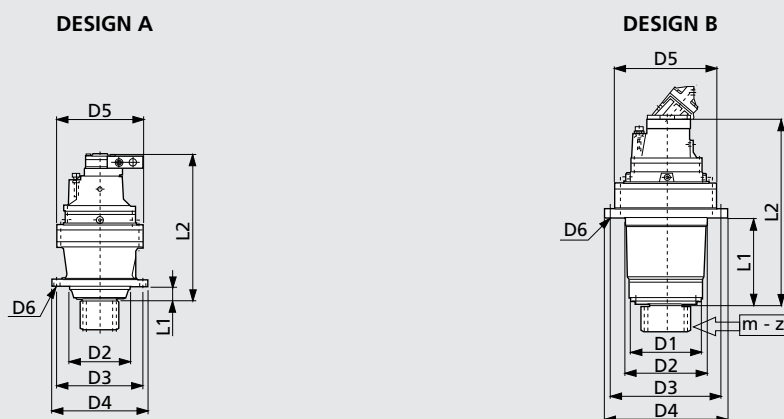

| TYPE    | D1  | D2  | D3  | D4  | D5  | D6       | L1  | L2   | m | z |
|---------|-----|-----|-----|-----|-----|----------|-----|------|---|---|
| 700 T F | -   | 150 | 195 | 220 | 186 | 12.5     | 31  | 300  |   |   |
| 701 T F | -   | 150 | 195 | 220 | 186 | 12.5     | 31  | 325  |   |   |
| 703 T F | -   | 175 | 245 | 272 | 245 | 18       | 41  | 410  |   |   |
| 704 T F | -   | 175 | 245 | 272 | 245 | 18       | 41  | 400  |   |   |
| 705 T F | -   | 175 | 245 | 272 | 245 | 18       | 41  | 440  |   |   |
| 705 T L | 180 | 195 | 245 | 290 | 245 | 13       | 171 | 470  |   |   |
| 706 T N | 200 | 250 | 325 | 360 | 292 | 17       | 225 | 560  |   |   |
| 707 T N | 230 | 280 | 314 | 348 | 345 | 17       | 295 | 670  |   |   |
| 709 T N | 250 | 280 | 380 | 420 | 345 | 17       | 295 | 720  |   |   |
| 710 T N | 300 | 425 | 460 | 500 | 400 | 22       | 360 | 730  |   |   |
| 711 T C | 300 | 425 | 460 | 500 | 428 | 22       | 345 | 735  |   |   |
| 711 T F | 500 | 320 | 500 | 560 | 425 | 22       | 70  | 750  |   |   |
| 712 T F | -   | 410 | 450 | 490 | 420 | ø21 n°24 | 120 | 900  |   |   |
| 712 T N | 400 | 425 | 470 | 510 | 420 | ø20 n°30 | 350 | 900  |   |   |
| 713 T N | 340 | 400 | 510 | 560 | 445 | 22       | 420 | 1030 |   |   |
| 714 T F | -   | 420 | 490 | 530 | 490 | ø22 n°24 | 160 | 1100 |   |   |
| 715 T N | 370 | 470 | 600 | 640 | 542 | 22       | 465 | 1250 |   |   |

Module / number of teeth of pinion UPON REQUEST

# 700TK series Slew drives



The 700TK series are the ideal compact and yet powerful package for the slew drive of excavators up to approx. 120 ton class.

The units are powered by integrated axial piston hydraulic motors, developed in cooperation with KAYABA and can be accommodated within the smallest space.

Wide choice of drive pinions, standard or to customer specs.



### Torque Range

750 ... 30000 Nm

### Excavator weight

1.5 to 120 Ton

### Gear Ratios

7 ... 40

### Key Features

- Flange mounted
- Output shaft with integral pinion
- Rugged construction
- High torque capacity
- Output shafts supported by heavy duty bearings
- Compact design

### Hydraulic motors

KAYABA hydraulic motor fixed displacement complete with shockless type pressure relief valve

### Motor options

Anti swing-back valve

### Brake

- Hydraulically released failsafe parking brake
- Brake retarder valve on request

| Type     | Excavator Torque (Nm) |
|----------|-----------------------|
| 700 T1 K | 750                   |
| 701 T2 K | 1200                  |
| 703 T2 K | 2500                  |
| 705 T2 K | 5000                  |
| 706 T2 K | 7500                  |
| 707 T2 F | 9000                  |
| 709 T2 F | 11000                 |
| 710 T2 F | 15000                 |
| 711 T2 F | 24000                 |
| 713 T2 F | 30000                 |



# Overall dimensions and technical data

| TYPE     | GEARBOX | MOTOR DISPLACEMENT | MAX. PRESSURE | MAX. FLOW | PARKING BRAKE |    | RANGE OF RATIO | APPROX. WEIGHT OF MACHINE |
|----------|---------|--------------------|---------------|-----------|---------------|----|----------------|---------------------------|
|          | nbr     | cm                 | bar           | l/min     | Yes           | No | 1:             | Ton                       |
| 700 T1 K | 1       | 27.4               | 210           | 18        | •             | •  | 8.2            | 1.5 - 2.5                 |
| 701 T2 K | 1       | 27.4               | 210           | 30        | •             | •  | 13.7-20.8      | 3 - 4                     |
| 703 T2 K | 1       | 27.4               | 250           | 50        | •             | •  | 14.8-35.6      | 5 - 6                     |
| 705 T2 K | 1       | 44.1               | 280           | 80        | •             |    | 18-26.3        | 7 - 8                     |
| 706 T2 K | 1       | 87.3               | 320           | 160       | •             |    | 15.3-33        | 9 - 13                    |
| 707 T2 F | 1       | 87.3               | 320           | 160       | •             |    | 14.7-22.3      | 15 - 18                   |
| 709 T2 F | 1       | 130-160-180        | 270 ÷ 290     | 180 ÷ 240 | •             |    | 19-25          | 21 - 26                   |
| 710 T2 F | 1       | 160-180            | 270 ÷ 290     | 250       | •             |    | 22-26          | 26 - 30                   |
| 711 T2 F | 1       | 210                | 270 ÷ 290     | 290       | •             |    | 21-25          | 30 - 35                   |
| 709 T2 F | 2       | 130-160-180        | 270 ÷ 290     | 180 ÷ 240 | •             |    | 19-25          | 35 - 45                   |
| 710 T2 F | 2       | 160-180            | 270 ÷ 290     | 250       | •             |    | 22-26          | 45 - 60                   |
| 711 T2 F | 2       | 210                | 270 ÷ 290     | 290       | •             |    | 21-25          | 60 - 80                   |
| 713 T2 F | 2       | 160-180            | 270 ÷ 290     | 270       | •             |    | 25-35          | 80 - 120                  |

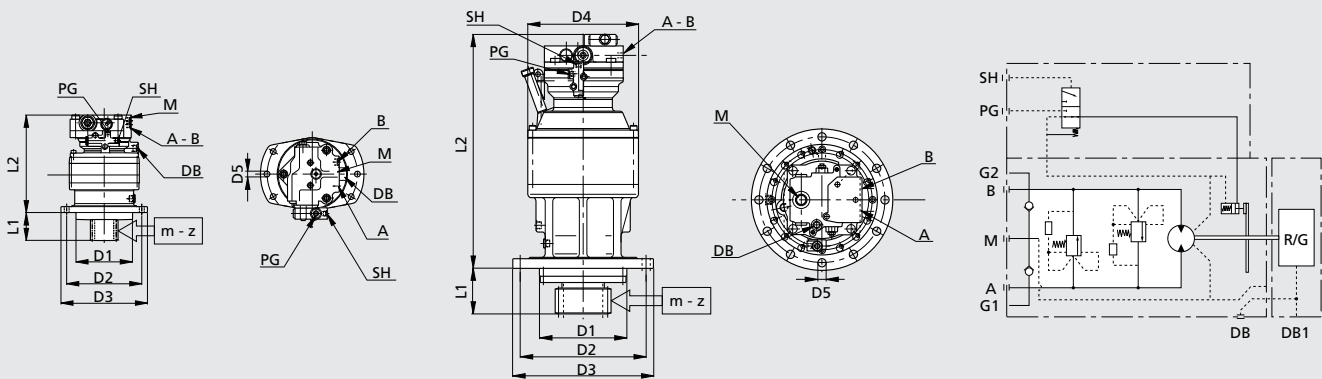

| TYPE     | D1  | D2  | D3  | D4  | D5        | D6  | A-B       | DB         | M                   | SH                   | PG                 | m   | z |
|----------|-----|-----|-----|-----|-----------|-----|-----------|------------|---------------------|----------------------|--------------------|---|---|
| 700 T1 K | -   | 228 | 260 | 186 | ∅ 13 n°6  | 76  | MAIN PORT | DRAIN PORT | ANTICAVITATION PORT | SPOOL OPERATING PORT | BRAKE RELEASE PORT | Module / number of teeth of pinion UPON REQUEST |   |
| 701 T2 K | 175 | 228 | 260 | 186 | ∅ 13 n°6  | 86  |           |            |                     |                      |                    |   |   |
| 703 T2 K | 175 | 245 | 272 | 244 | ∅ 18 n°10 | 120 |           |            |                     |                      |                    |   |   |
| 705 T2 K | 230 | 245 | 272 | 244 | ∅ 18 n°10 | 120 |           |            |                     |                      |                    |   |   |
| 706 T2 K | 230 | 332 | 372 | 292 | ∅ 22 n°10 | 150 |           |            |                     |                      |                    |   |   |
| 706 T2 K | 270 | 332 | 372 | 292 | ∅ 22 n°10 | 150 |           |            |                     |                      |                    |   |   |
| 707 T2 K | -   | 360 | 410 | 348 | ∅ 22 n°12 | 160 |           |            |                     |                      |                    |   |   |
| 707 T2 F | -   | 360 | 410 | 348 | ∅ 22 n°12 | 160 |           |            |                     |                      |                    |   |   |
| 709 T2 F | 270 | 360 | 410 | 348 | ∅ 22 n°12 | 160 |           |            |                     |                      |                    |   |   |
| 710 T2 F | 390 | 460 | 510 | 400 | ∅ 22 n°12 | 160 |           |            |                     |                      |                    |   |   |
| 711 T2 F | 370 | 470 | 520 | 430 | ∅ 22 n°12 | 160 |           |            |                     |                      |                    |   |   |
| 713 T2 F | 550 | 600 | 660 | 445 | ∅ 26 n°24 | 350 |           |            |                     |                      |                    |   |   |