

- **Aluminum container with PE insert**
- **Capacity: 5 liter**
- **Used for low and medium viscosity media for up to 10,000 mPas**
- **Pressure in the container max. 3.8 bar**
- **1 or 2 level sensors for the indication of topping-up and empty signals available as accessories**

**Technical data:**

Filling volume	7.45 l (Net filling quantity)
Maximum pressure	3.8 bar
Test pressure	5 bar
Operating temperature	5 – 45° C
Product	low and medium viscosity media up to 10,000 mPas
Compressed air connection	thread connection R 1/4" i
Connection to product	thread connection R 1/4" i
Weight	approx. 12 kg

**Dimensions:**

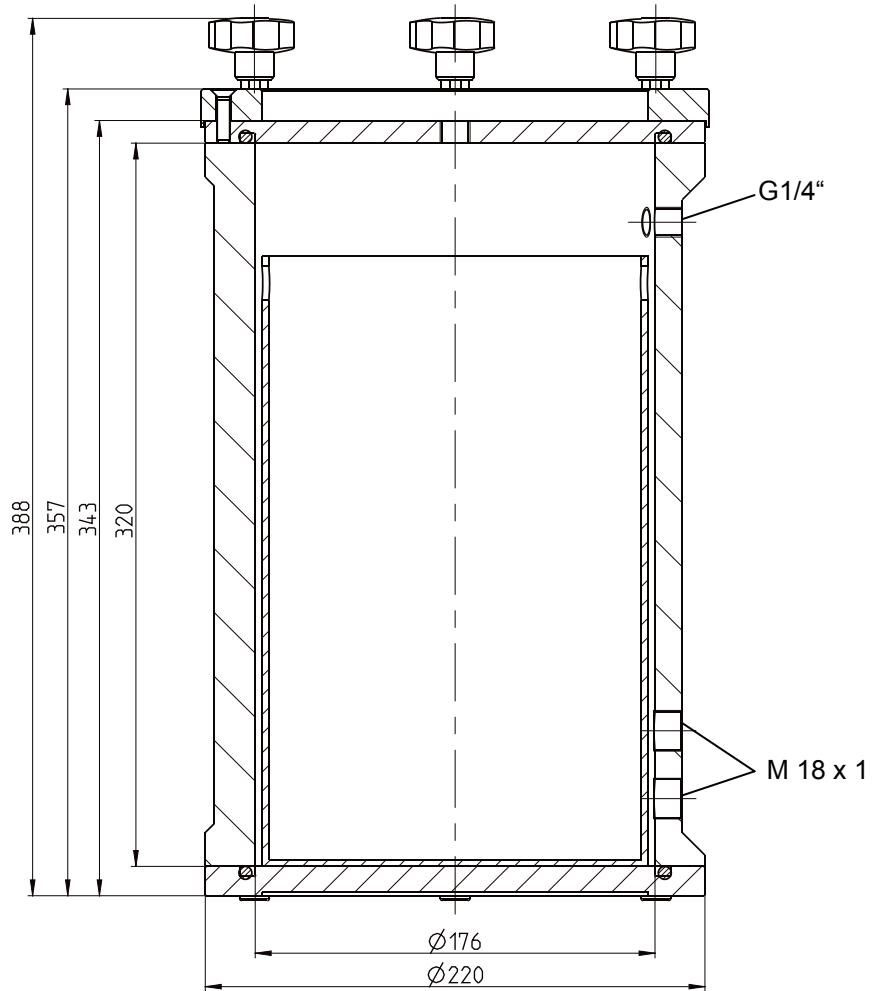

Effective pressure area:

$\varnothing_i = 170$  mm

$H_1 = 314$  mm (completely)

$H_2 = 268$  mm (to bore)

**Ordering data:**

**Article/Nomenclature**

**Material no.**

5.0 l aluminum pressure vessel  
with PE container insert

295256



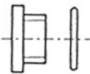
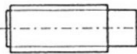

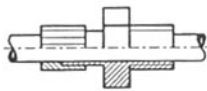

### Accessories:

	<b>Article/Nomenclature</b>	<b>Material no.</b>
	optional:	
	- <b>without indication of the topping-up and empty signals</b>	
	2 screw plugs M 32 x 1.5	39525606
	2 O-rings Ø 18 x 2	417009023
	- <b>with indication of empty signal, without indication of topping-up signal</b>	
	1 capacitive key M 18 x 1, pnp version (suitable for Multiline 1000 and 6000)	417504157
	<i>plus</i>	
	1 plug with 5 m cable	417504151
	1 screw plug M 18 x 1	39525606
	1 O-ring Ø 18 x 2	417009023
	- <b>with indication of empty and topping up signals</b>	
	2 capacitive keys M 18 x 1, pnp version (suitable for Multiline 1000 and 6000)	417504157
	<i>plus</i>	
	2 plugs with 5 m cable	417504151

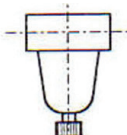
### Accessories (container outlet):

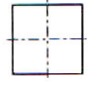
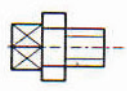
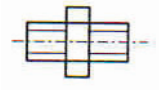
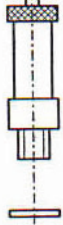
	Product hose Ø 4/6 mm material: transparent PE	417400301
	Product hose Ø 6/8 mm material: transparent PE	417400310
	Product hose Ø 4/6 mm material: PTFE	417400215
	Product hose Ø 6/8 mm material: PTFE	417400224
	Passage screw connection R 1/4" for product hose Ø 4/6 mm, material: PA	39520412
	Passage screw connection R 1/4" for product hose Ø 6/8 mm, material: PA	39520413

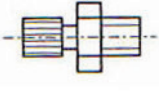
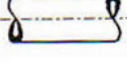
### Accessories (container inlet):

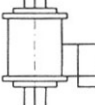
	Article/Nomenclature	Material no.
	Pressure control valve 0 – 1.6 bar 2 x R 1/4", 1 x R 1/8"	415501005
	Pressure control valve 0 - 4 bar	415501009
	Pressure gauge R 1/8", 0 – 1.6 bar	415502554
	Pressure gauge R 1/8", 0 - 6 bar	415502555
	Al distributor piece 4 x R 1/4"	39030101
	Blank plug R 1/4" material: brass	415203702
	Double nipple R 1/4", brass material: brass	415203582
	Safety valve R 1/4", 1.6 bar	415503660
	Safety valve R 1/4", 3.8 bar	415700006
	Sealing ring for safety valve	417010103
	Straight screw connection R 1/4", Al for compressed air hose Ø 4/6 mm	415100777
	Compressed air hose Ø 4/6 mm material: blue PE max. 50 m	417400352
	Reducing nipple R 1/4" - R 1/8" material: brass	415204771
	Filling valve (coaxial) for automatic filling of the container with oil	J16-13

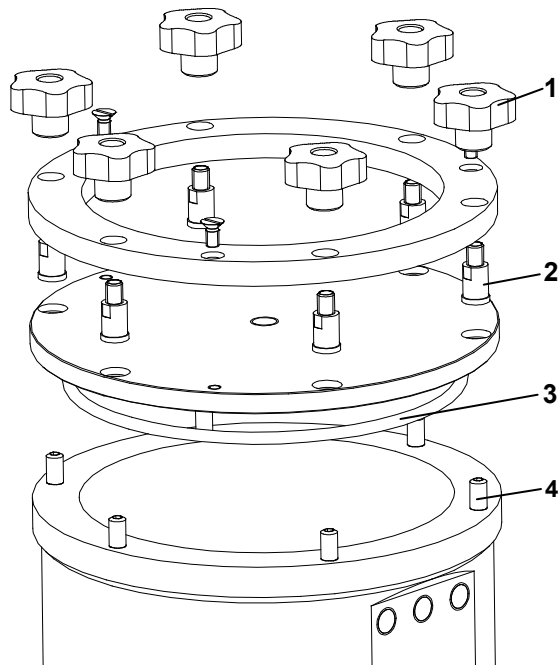
**Spare parts:**

<b>Item</b>	<b>Article/Nomenclature</b>	<b>Material No.</b>
1	ELESA Star knob	419800791
2	Lid screw	39525605
3	O-Ring Ø179.2 x 5.7	417003240
4	Set screw M 8 x 40, DIN 913	413405091